

2402, 1830, OCEAN DR, HALLANDALE BEACH, FL, 33009

<https://beachclubhallandale.org>

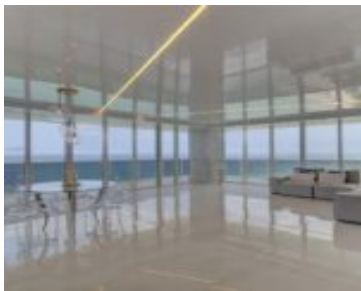

BEACH CLUB TWO CONDO UNIT 2402 PER CDO CIN# 106268982 Welcome to the pinnacle of elegance and sophistication at Beach Club Two's newly renovated corner apartment. Designed to perfection, this southeast-facing residence in the most coveted line 02 offers the most desirable features. Step inside to be greeted by a false ceiling with ocean reflections [...]

- 3 beds
- 3 baths
- Condominium
- Residential
- Active
- 2065 sq ft

Basics



Category: Residential

Status: Active

Bathrooms: 3 baths

Floors: 52 floors

Year built: 2006

Subdivision Name: BEACH CLUB TWO CONDO

Type: Condominium

Bedrooms: 3 beds

Half baths: 0 half baths

Area: 2065 sq ft

View: Ocean

County: Broward County

Building Details

Architectural Style: HighRise

Covered Spaces: 1

Floor covering: Tile

Construction Materials: Block

Garage Spaces: 1

Amenities & Features

Pool Features: Heated

Security Features:
DoorMan,ElevatorSecured,KeyCardEntry

Waterfront Features: OceanAccess

Exterior Features:
SecurityHighImpactDoors

Heating: Electric

Laundry Features:
WasherHookup,DryerHookup

Parking Features: Assigned,OneSpace,Valet

Association Amenities: Pool,Sauna,SpaHotTub,Elevators

Cooling: CentralAir,Electric

Furnished: Furnished

Interior Features:
Bidet,BuiltInFeatures,DualSinks,CustomMirrors,Other,SeparateShower,WalkInClosets

Appliances: Dryer,Dishwasher,Disposal,Refrigerator

Expenses, Fees & Taxes

Association Fee: \$930

Tax Year: 2023

Tax Annual Amount: \$25,119

Miscellaneous



Association Fee Frequency: Monthly **List Office Name:** Big International Realty, Inc.

Listing Terms: Cash,Conventional **Direction Faces:** East

